



ROHS-Compliant Product

O-6000AT Series



1. Specification		
Frequency range:	5 ... 100 MHz	
Type:	O-6500AT	O-6300AT
Supply voltage V_S :	+5.0 V \pm 5 %	+3.3 V \pm 5 %
Frequency stability vs. temperature options:		
$\leq \pm 2 \times 10^{-8}$ vs. 0 °C to +50 °C:	650x	630x
$\leq \pm 3 \times 10^{-8}$ vs. -10 °C to +60 °C:	651x	631x
$\leq \pm 1 \times 10^{-7}$ vs. -20 °C to +70 °C:	652x	632x
$\leq \pm 5 \times 10^{-8}$ vs. -20 °C to +70 °C:	653x	633x
$\leq \pm 1 \times 10^{-7}$ vs. -40 °C to +85 °C:	654x	634x
Aging stability option (after 30 days of continuous operation)		
$< \pm 1 \times 10^{-9}$ / day; $< \pm 1 \times 10^{-7}$ / year:	65x1	63x1
$< \pm 2 \times 10^{-9}$ / day; $< \pm 2 \times 10^{-7}$ / year:	65x2	63x2
$< \pm 3 \times 10^{-9}$ / day; $< \pm 3 \times 10^{-7}$ / year:	65x3	63x2
Frequency stability vs. supply voltage changes $V_S \pm 5$ %: vs. load changes ± 5 %:	$\leq \pm 1.0 \times 10^{-8}$ $\leq \pm 5.0 \times 10^{-9}$	
Frequency control by external voltage 0 V ... V_{REF} :	$\geq \pm 3$ ppm	
Transfer function / Linearity:	Positive / ≤ 10 %	
Reference voltage V_{REF} :	+4.0 V \pm 5 %	+3.0 V \pm 5 %
Power consumption @ +25 °C steady state: during warm-up:	≤ 1.5 W ≤ 3.5 W	
Warm-up time: (for a typical accuracy of $\leq \pm 5 \times 10^{-8}$ @ +25 °C referred to final frequency after 1 hour)	≤ 5 min	
Output voltage / Load Option H : Option S :	HCMOS / 1 kOhm // 15 pF Sinewave / $\geq +3$ dBm / 50 Ohm	
Phase noise:	(typical for 10 MHz)	
10 Hz:	-90 dBc / Hz	
100 Hz:	-125 dBc / Hz	
1 kHz:	-140 dBc / Hz	
10 kHz:	-150 dBc / Hz	
Storage temperature range:	-45 °C ... +90 °C	



ROHS-Compliant Product

O-6000AT Series



2. Environmental conditions

According to KVG Product Qualification Procedure AA-QM-200

3. Marking

Manufacturer's name, date code (week/year); Specification; Center frequency

4. Case

BF144-11.5-SMD

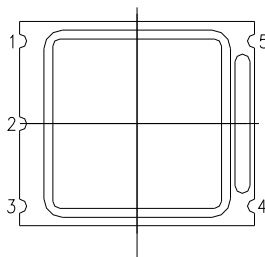
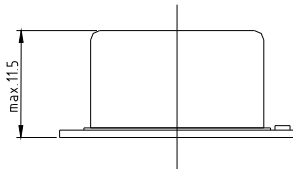
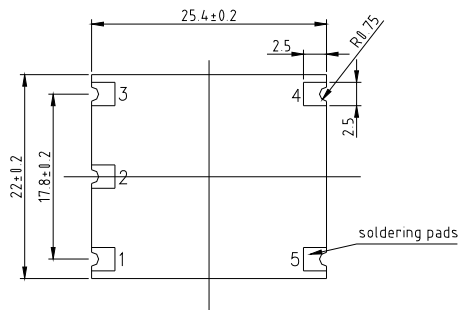

Foot print
for PCB Design

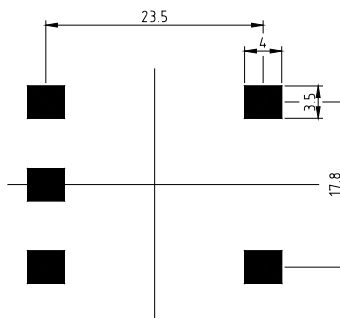

1. Pin configuration

1. Control voltage V_C
2. Reference voltage output V_{REF}
3. Supply voltage V_S
4. RF-output
5. Ground, case



ROHS-Compliant Product

O-6000AT Series



5. Recommended soldering profile

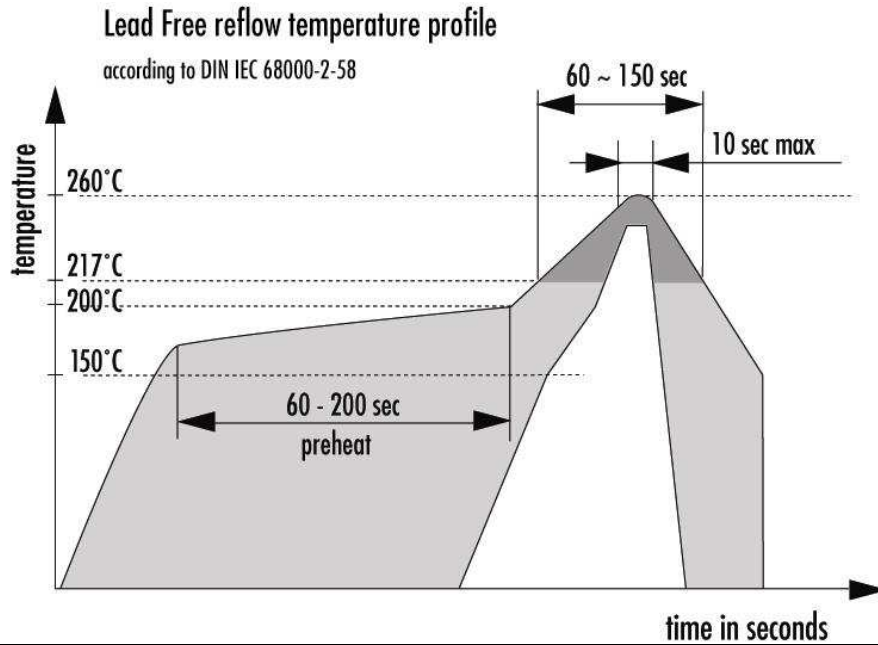

6. Tape and reel

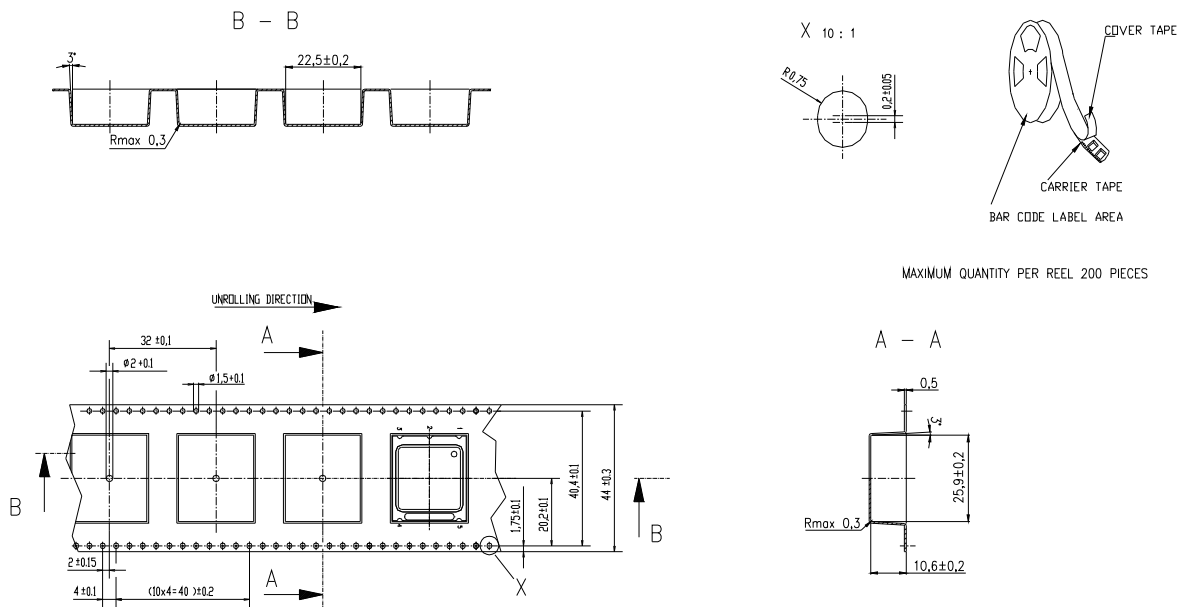

max. pcs per tape: 150